

MARINE NOTICE NO PA0718

Navigation Warning – Artificial Reef Installation, Merimbula Bay

19 September 2018

THE WORKS

The works include installation of two x 11m long, 8m wide and 12m high 90tonne structures to form an artificial reef system. The structures will be placed on the seabed in approx 30m of water allowing navigable draft of 18m.

NAVIGATION WARNING

The structures will be located in the following locations;

Northern tower 36 54.840 S, 149 56.251 E

Southern tower 36 54.894 S, 149 56.251 E

Vessel operators are advised to exercise **caution** when navigating in the vicinity and avoid the use of trawling gear in this area.

This navigation warning remains in place for the duration of the works and charts will be updated in the near future.

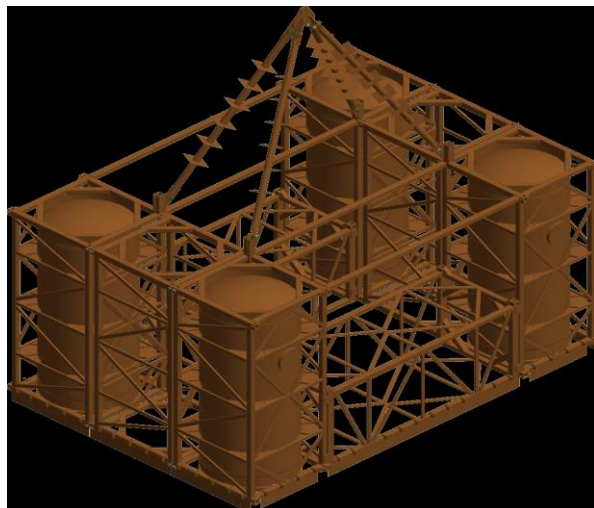

MAPS & CHARTS AFFECTED

AUS 806

For further information concerning this Notice to Mariners, please contact the Eden Harbour Master for the Port of Eden,

Ph: (02) 6496 1719 or Email: edenpilots@portauthority.nsw.gov.au